

North Lanarkshire Council Report

Education, Children and Families Committee

Does this report require to be approved? Yes No

Ref GMcL/MD

Date 21/05/24

Proposal for statutory public consultation on the proposed new build for Glenboig Primary

From Gerard McLaughlin, Chief Officer (Education North)

E-mail mclaughling@northlan.gov.uk **Telephone** 01236 812 221

Executive Summary

This report outlines the proposal for a statutory public consultation on a proposed new build school for Glenboig Primary School.

If approved, a statutory consultation will take place involving all statutory consultees, other stakeholders and interested parties.

The key reasons for this proposal are:

- The growing and increased population within the Glenboig catchment area, primarily due to the Community Growth Area which is a strategic development for housing within this part of North Lanarkshire. There is insufficient capacity at the existing joint campus to provide adequate provision for the projected number of pupils at both existing schools.
- It is proposed that the school will be sited on an area of land to the Southwest of the existing school and to the East of Glenboig Road (Appendix 2).

The pupils currently at Glenboig Primary School will benefit educationally by attending a new build school which can offer a wider range of educational opportunities and of adequate size to support learning and teaching.

Recommendations

It is recommended that the Education, Children and Families Committee:

- (1) Endorse the contents of the report;
 - (2) Agree that a formal consultation take place on the proposed new build for Glenboig Primary;
 - (3) Endorse the attached statutory consultation document Appendix 1;
 - (4) Agree the timeline for consultation outlined in Appendix 3 of this report.
-

The Plan for North Lanarkshire

Priority	Improve North Lanarkshire's resource base
Ambition statement	(22) Facilitate a North Lanarkshire wide approach to asset rationalisation, including with communities and partners
Programme of Work	Invest in North Lanarkshire

1. Background

Schools (Consultation) (Scotland) Act 2010

- 1.1 The provisions of the above Act place a statutory duty on education authorities to carry out formal consultations on new build proposals for schools when the proposal is to build the school out with its current curtilage or when a joint campus is proposed involving a non-denominational and a denominational primary school.
 - 1.2 The Act requires education authorities prepare an educational benefits statement, to prepare (and publish) a proposal paper in respect of any proposal which falls within the terms of the Act, give notice of the proposal to the relevant consultees (and invite representations) in accordance with the Act, to hold (and give notice of) a public meeting, involve Education Scotland.
 - 1.3 Following the period of consultation, the education authority must review the proposal in accordance with the Act and prepare (and publish) a consultation report in accordance with relevant sections of the Act.
 - 1.4 After publication of the education authority report, HMIE publish a report on the consultation taking account of the previously published education authority report before a final decision is made by the Council.
 - 1.5 The Service will undertake a statutory consultation on the proposed relocation of Glenboig Primary to a new location. Appendix 2.
 - 1.6 Proposals outlined in this paper have been developed by Education and Families Managers including staff from the Early Learning & Childcare team, the Inclusion team, Assets and Procurement and Corporate Finance. Key considerations derived from these meetings have been incorporated into the models proposed, which include:
 - Availability of spaces to serve the needs of the local primary school population
 - Quality and condition of the fabric of school buildings
 - Possible savings/costs associated with estate re-purposing and school relocation
 - Impact assessment and improvement planning for the ASN sector.
 - 1.7 The Service has adopted a formal project management governance structure to lead and monitor the delivery of new build schools.
 - 1.8 The final decision of the education authority is subject to review and possible call in by the Scottish government which must operate to a strict timeline set out in Appendix 3.
 - 1.9 The timeline mentioned above may be subject to review due to unforeseen circumstances.
-

2. Report

2.1 The council is progressing, through the Town and Community Hub programme budget allocation, a new build Glenboig Community Hub which will include 292 primary school spaces at a new location and thereafter relocate Glenboig Primary School to this new Community Hub. As members will be aware, Glenboig is part of a Community Growth Area and is experiencing increased demand to the school estate as a result. The current location does not have sufficient space on which to expand to create the capacity required, therefore a new school, at a new location is proposed, with the existing joint campus being converted into a single school for the Our Lady and St Joseph Primary School. A statutory education consultation is required to relocate a primary school to the new location.

2.2 There are various reasons why a new build is prioritised:

“Legacy” projects which are carried over from previous school build programmes such as “Schools and Centres 21”;

“Capacity” projects which are required due to significant increased pupil populations and subsequent additional spaces required within catchment schools;

and “Policy” projects which are brought forward due to alignment with the prioritisation matrix linked to the Town and Community Hub programme.

Glenboig Community Hub is a capacity related project, and as such is prioritised within the 2024-2029 capital allocation for this programme of work.

2.3 A number of factors were used to establish an approach to prioritising potential rationalisation activities. These are described in the following section.

Strategic fit with the priorities of the Plan for North Lanarkshire;

2.4 This project will be delivered as part of the council’s Town and Community Hub Programme and will follow the six guiding principles attached to the Town and Community Hub programme. As such, in addition to the required Statutory Education Consultation, there will be effective engagement with both the school and the wider community throughout the design stage of this project – should it be approved to proceed following Statutory Consultation. It is proposed that the intelligent brief process, which facilitates engagement with the stakeholders, would not wait until the education consultation is concluded but will be ‘delivered at risk’. It is not the case that the outcome is predetermined – hence the ‘at risk’ proposal. The council is looking to deliver a new facility as soon as practically possible, due to pressures at the existing establishment. However, it should be noted that should the outcome of the Statutory Education Consultation conclude that the proposal should not be progressed, the work on the intelligent brief would cease.

Alignment with the Community Growth Area proposal;

2.5 It was always envisaged that a new build primary school would be required to serve the growing population of Glenboig, which is part of the Gartcosh and Glenboig Community Growth Area. The council is already progressing a new build Gartcosh Community Hub to increase spaces within this neighbouring community. The Gartcosh Community Hub was progressed ahead of the proposals for a new Glenboig Primary School as the housing in Gartcosh, and the availability of spaces at the existing Gartcosh Primary School, deemed that proposal a priority. Given the housebuilding in the Glenboig catchment area is now progressing, this is the correct time to bring forward the proposals for a new primary school to serve the Glenboig Community. The current learning spaces that Glenboig Primary School share with Our Lady and St Joseph’s at the existing joint campus will be assigned to Our Lady

and St Joseph's. Therefore, the creation of a new primary school, at a new nearby location, will facilitate increased capacity for both primary schools to serve this growing population.

3. Measures of success

- 3.1 Stakeholder support for the options brought forward.
- 3.2 Successful implementation of planned proposals.
- 3.3 Achievement of budget savings target in line with approved budget savings agreed by Council March 2024.
- 3.4 Greater alignment with Plan for North Lanarkshire community hub model.
- 3.5 Improved quality of service and provision to effectively meet the needs of children, young people and families.
- 3.6 Increased numbers of children and young people remaining within their local community.

4. Supporting documentation

- 4.1 Appendix 1 Statutory Consultation Glenboig Primary
- 4.2 Appendix 2 Location plan
- 4.3 Appendix 3 Statutory Consultation Timeline



Gerard McLaughlin
Chief Officer (Education North)

5. Impacts

5.1 Public Sector Equality Duty and Fairer Scotland Duty

Does the report contain information that has an impact as a result of the Public Sector Equality Duty and/or Fairer Scotland Duty?

Yes No

If Yes, please provide a brief summary of the impact?

An Equality Impact Assessment has been completed and will underpin planning for these proposals, since a number of the young people involved are considered as being from a protected group, due to disability.

If Yes, has an assessment been carried out and published on the council's website? <https://www.northlanarkshire.gov.uk/your-community/equalities/equality-and-fairer-scotland-duty-impact-assessments>

Yes No

5.2 Financial impact

Does the report contain any financial impacts?

Yes No

If Yes, have all relevant financial impacts been discussed and agreed with Finance?

Yes No

If Yes, please provide a brief summary of the impact?

The Service is currently assessing the value of this capital investment with support from colleagues in Asset and Procurement Solutions.

5.3 HR policy impact

Does the report contain any HR policy or procedure impacts?

Yes No

If Yes, have all relevant HR impacts been discussed and agreed with People Resources?

Yes No

If Yes, please provide a brief summary of the impact?

Affected staff will be managed in accordance with the appropriate Workforce Change Policies and in with the signatory trades unions. Considerations would include Compulsory Transfer, Premature/Early Retirement, Redundancy/Redeployment.

The Service would be required to follow the requirements for consulting as set out in the Schools (Consultation) (Scotland) Act 2010. Further stakeholder, community and parental consultation would be required in the event that the Service proceeds with any of the recommendations. An indicative timeline for the consultation process is outlined in Appendix 2.

5.4 Legal impact

Does the report contain any legal impacts (such as general legal matters, statutory considerations (including employment law considerations), or new legislation)?

Yes No

If Yes, have all relevant legal impacts been discussed and agreed with Legal and Democratic?

Yes No

If Yes, please provide a brief summary of the impact?

5.5	<p>Data protection impact Does the report / project / practice contain or involve the processing of personal data? Yes <input type="checkbox"/> No <input checked="" type="checkbox"/></p> <p>If Yes, is the processing of this personal data likely to result in a high risk to the data subject? Yes <input type="checkbox"/> No <input checked="" type="checkbox"/></p> <p>If Yes, has a Data Protection Impact Assessment (DPIA) been carried out and e-mailed to dataprotection@northlan.gov.uk Yes <input type="checkbox"/> No <input checked="" type="checkbox"/></p>
5.6	<p>Technology / Digital impact Does the report contain information that has an impact on either technology, digital transformation, service redesign / business change processes, data management, or connectivity / broadband / Wi-Fi? Yes <input type="checkbox"/> No <input checked="" type="checkbox"/></p> <p>If Yes, please provide a brief summary of the impact?</p> <p>Where the impact identifies a requirement for significant technology change, has an assessment been carried out (or is scheduled to be carried out) by the Enterprise Architecture Governance Group (EAGG)? Yes <input type="checkbox"/> No <input checked="" type="checkbox"/></p>
5.7	<p>Environmental / Carbon impact Does the report / project / practice contain information that has an impact on any environmental or carbon matters? Yes <input checked="" type="checkbox"/> No <input type="checkbox"/></p> <p>If Yes, please provide a brief summary of the impact?</p> <p>The carbon footprint will reduce if the numbers of establishments operating was reduced and pupils were catered for in our newer and more energy efficient campuses.</p>
5.8	<p>Communications impact Does the report contain any information that has an impact on the council's communications activities? Yes <input type="checkbox"/> No <input checked="" type="checkbox"/></p> <p>If Yes, please provide a brief summary of the impact?</p>
5.9	<p>Risk impact Is there a risk impact? Yes <input checked="" type="checkbox"/> No <input type="checkbox"/></p> <p>If Yes, please provide a brief summary of the key risks and potential impacts, highlighting where the risk(s) are assessed and recorded (e.g. Corporate or Service or Project Risk Registers), and how they are managed?</p> <p>A Programme Board has been established for the Implementation of the ASN Review.</p>
5.10	<p>Armed Forces Covenant Duty Does the report require to take due regard of the Armed Forces Covenant Duty (i.e. does it relate to healthcare, housing, or education services for in-Service or ex-Service personnel, or their families, or widow(er)s)? Yes <input type="checkbox"/> No <input checked="" type="checkbox"/></p> <p>If Yes, please provide a brief summary of the provision which has been made to ensure there has been appropriate consideration of the particular needs of the</p>

Armed Forces community to make sure that they do not face disadvantage compared to other citizens in the provision of public services.

5.11 Children's rights and wellbeing impact

Does the report contain any information regarding any council activity, service delivery, policy, or plan that has an impact on children and young people up to the age of 18, or on a specific group of these?

Yes No

If Yes, please provide a brief summary of the impact and the provision that has been made to ensure there has been appropriate consideration of the relevant Articles from the United Nations Convention on the Rights of the Child (UNCRC).

If Yes, has a Children's Rights and Wellbeing Impact Assessment (CRWIA) been carried out?

Yes No

Appendix 1

Statutory Consultation

Proposal to build a new Glenboig Primary School

EDUCATION AND FAMILIES



NORTH LANARKSHIRE COUNCIL: EDUCATION AND FAMILIES

Proposal to build a new Glenboig Primary School

1. INTRODUCTION

Glenboig Primary School is a non-denominational primary school which is co-located with Our Lady and St Joseph's Primary School. The joint campus was built as part of the council's Public Private Partnership (PPP) initiative and opened in 2006.

The school capacity of the school is 113 with the current roll of 120.

2. CONSULTATION REQUIREMENTS

- 2.1 In terms of the Schools (Consultation) (Scotland) Act 2010, the Education Authority is required to publish details of, and consult on any proposal to establish a new school and on any proposal to establish, terminate or otherwise alter the catchment area of a school.
- 2.2 North Lanarkshire Council will not make any decision, or put any changes into effect, until the consultation period has been concluded in line with statutory requirements.
- 2.3 The consultation period begins on 4 November 2024 and finishes on 16 December 2024, which include 30 school days.
- 2.4 The consultation will involve pupils, parent/carers, Parent Councils and staff of the schools involved, as well as other associated stakeholder and statutory consultees.
- 2.5 A public meeting will be held on week beginning 25 November 2024.
- 2.6 Council officers will be present at the public meeting to discuss the proposal. There will be limited time at the meeting to discuss all issues fully. To ensure that all issues are covered and that those who may be uncomfortable with speaking publicly are heard, advance notice of specific questions or issues to be raised will be accepted in writing up to two days in advance of the meeting – see contact details at 2.9.
- 2.7 At the end of the consultation process, a report will be prepared for North Lanarkshire Council detailing all responses received, summaries of their content and a statement from Education Scotland on the educational aspects of the proposal. Responses to the issues raised through the consultation will also be incorporated in the report. Copies of the report will be available, prior to consideration by the council, in the affected schools and online. It is envisaged that the report will be published on March 2025.
- 2.8 An online version of the document and other items related to the consultation can be found online at www.northlanarkshire.gov.uk/Glenboig-consultation
- 2.9 Further information on the proposal can be obtained by sending an email to Glenboigconsultation@northlan.gov.uk
- 2.10 All interested parties are invited to submit their comments on or before 16 December 2024.

3. PROPOSAL

- 3.1 The proposal in this document is to build a new facility incorporating a new build

Glenboig Primary School. There are two main reasons for this proposal:

- The pupils currently at Glenboig Primary School will benefit educationally by attending new build schools which can offer a wider range of educational opportunities (see Educational and Community Benefits sections below) in a facility with an adequate number of learning and teaching spaces to serve this pupil population.
- The current joint campus which Glenboig Primary School shares with Our Lady and St Joseph's Primary School does not have sufficient capacity to serve the growing population in this area. The decoupling of Glenboig Primary School from the existing joint campus will provide new facilities for Glenboig Primary School and create additional capacity for Our Lady and St Josephs within the existing school grounds.

3.2 It is proposed that the school will be sited on an area of land to the Southwest of the existing school and to the East of Glenboig Road.

3.3 If, following this statutory consultation, the Council proceeds with the proposed school, Glenboig Primary School will remain within the existing joint campus until the new school is deemed operational.

4. EDUCATION BENEFITS STATEMENT

4.1 Through the planned proposals it is expected that several education benefits will be achieved on behalf of children and young people including:

- It will provide better learning opportunities for the children of Our Lady & St Joseph's Primary School and Glenboig Primary School.
- Currently, the use of shared spaces within the joint campus is under pressure with the numbers of children attending. The roll in both schools is likely to grow over time making the situation more difficult.
- The new school will allow both St Kevin's Primary School and Bargeddie Primary School to use space more flexibly. Presently, staff find it difficult to find areas to work quietly with small groups or individual children. In this, as well as other regards, the proposal will bring benefits to all children including those with additional barriers to learning.
- The new school will be built to facilitate greater opportunities for active and outdoor learning whilst also making best use of the latest technology to enhance digital learning.

4.2 Experience in new school buildings has demonstrated that a new and flexible learning environment inspires staff and pupils and has a positive impact on the general health and wellbeing of stakeholders.

4.3 There will be the opportunity to provide similar high-quality facilities for learning to be designated in such a way as to allow a range of teaching styles and approaches, including active learning, interdisciplinary learning and outdoor learning.

4.4 The new school will be fully accessible to disabled learners as required by the Equality Act (2010). This will be ensured through the delivery of the Council's:-

- Equality outcomes

- Promoting Inclusive Design Protocol and
 - Partnership with North Lanarkshire Disability Access Panel.
- 4.5 The new school will be designed in such a way as to promote accessible, inclusive learning which will meet the needs of all learners including those with Additional Support Needs.
- 4.6 The new school will build on current, and facilitate new, opportunities for effective integrated working with other services and partner agencies and will provide necessary support to children and families in the new school catchment area.
- 4.7 The new school's design, construction and operation will be environmentally and energy efficient; contributing directly to delivering the year-on-year reductions in greenhouse gas emissions introduced by the Climate Change (Scotland) Act 2009 and provide a rich context for learning for children and young people about sustainability now and in the future.
- 4.8 The inclusion of LCSC and Early years and Childcare provision in the new build proposal will provide a fully up-to-date setting for LCSC and Early Years provision in the Glenboig area.

5. COMMUNITY BENEFITS STATEMENT

- 5.1 The current council education estate framework has delivered added value through:
- Several apprenticeships have been created on the construction of the new schools.
 - Local employment opportunities.
 - Meaningful learning and engagement between the framework partners and the project schools.
 - Over 70% of the total investment is being procured through local supply chains.
- 5.2 In order to maximise the level of local community benefit regular meetings take place with framework contractors and the council's Estate Teams. As we move forward at the pre-qualification stage contractors appointed to the framework and their supply chains will be required to actively participate in the achievement of social, environmental and sustainability policy objectives relating to local regeneration, social and economic growth, recruitment and training along with local supply chain initiatives. In addition, sustainability will be a key objective on the construction of the new schools thereby contributing to the Councils target of reducing our carbon footprint.
- 5.3 As well as the educational benefits allocated to the specific school projects there will be wider educational benefits to the North Lanarkshire Community in that, with the significant level of savings required to be made over the next few financial years, the best value argument is that we would be utilising resources more efficiently and effectively. This is in line with 2003 Best Value Legislation and the demands of the Education Scotland Act 1980.

6. IMPLICATIONS OF THE PROPOSALS

6.1 Rolls and Capacities

The projected rolls exclude placing requests but include house building estimates.

Table 3: Projected rolls and capacities for Glenboig Primary School 2024 - 2026

School	Capacity	Roll 2024		Roll 2025		Roll 2026	
		Roll	%	Roll	%	Roll	%
Permanent	113	120	106	131	116	150	133

The projected rolls exclude placing requests but include house building estimates. The roll is expected to increase further in future years as the house building in this area continues.

6.2 Transport to School

Council Policy currently provides free transport to those pupils living more than one mile from their zoned Primary School or where an appropriate walking route is not available. Education & Families will arrange for an assessment of the walking routes to the site of a new school and appropriate road crossing patrols will be established if considered necessary.

6.3 Staffing

The proposal should not have significant implications for staffing, either teaching or non-teaching. Any matter which arises will be dealt with within the terms of local and national agreements.

6.4 Secondary Education

The current zoning arrangement for secondary education is that pupils attending Glenboig Primary School attend Chryston High School. No change to the primary to secondary transfer arrangements will be required as a result of this proposal. Parents who wish their children to attend an alternative secondary school will require to submit a placing request for their preferred school.

6.5 Class Sizes

Class structures are decided by the head teacher in accordance with authority guidelines and take account of a range of factors, including teacher deployment, school policies, the available accommodation and pupil numbers at each stage.

6.6 Future use of the existing school buildings

The existing spaces within the existing joint campus will be handed over to the existing Our Lady and St Joseph's Primary School. Effectively, the existing joint campus will become a site serving a single school – Our Lady and St Joseph's, with the signage etc. being updated once Glenboig Primary School relocate to the new location.

6.7 Financial implications

Based on previous experience of new build projects within North Lanarkshire, it is anticipated this proposal will have a limited impact on school revenue budgets.

6.8 Placing Requests

It is anticipated that there will be no impact on pupils attending either school on a placing request. The following options exist for pupils in this position. Firstly, they can transfer

to the new school. Secondly, they can enrol in their designated catchment area school or thirdly, submit a placing request to another School. The parents of these pupils will be given the opportunity to discuss their preference with Education & Families staff. Parents remain responsible for transport costs where an existing placing request to the new build school is continued.

7. EQUALITY IMPACT ASSESSMENT

- 7.1 An Equality Impact Assessment has been completed and will underpin planning for these proposals, since a number of the young people involved are considered as being from a protected group, due to disability.

8. INACCURACIES OR OMISSIONS

- 8.1 There is a statutory requirement for the Council to consider any allegation of an inaccuracy or omission in the proposal paper and determine whether the allegation has foundation. Where inaccuracies or omissions are notified to, or discovered by, the Council within this proposal document, the Council will determine if relevant information has, in its opinion been omitted or whether there is in fact an inaccuracy.

Notifiers of any omissions or inaccuracies will be informed of the Council's decision and the reasons for that decision. Notifiers will also be informed of any action. The Council will invite the notifiers to make further representations to the Council should they disagree with the Council's determination or its decision as to whether to take action.

- 8.2 If the Council has found, either itself or through a concern being raised, that there is an inaccuracy or omission in the proposal paper, it must decide whether this relates to a material consideration relevant to the proposal.

Where the confirmed inaccuracy or omission relates to a material consideration, there is a duty on the Council to correct it.

- 8.3 Appropriate action will then be taken by the Council depending on whether the inaccuracy or omission relates to a material consideration.

Such action may include withdrawing the proposal and issuing a revised proposal paper for the whole consultation period, or issuing a corrected proposal paper with, if, an extension of the consultation period. In any of these eventualities, all relevant consultees (and, where applicable, the notifier(s) of any omissions or inaccuracies) and HMIE (Education Scotland) will be advised of the action.

Where inaccuracies or omissions are discovered within the proposal document, the Council will determine whether relevant information has been omitted or if there has been an inaccuracy. action will then be taken by the Council, which may include issuing corrections, issuing a corrected proposal document, or an extension of the consultation period. In any of these eventualities, all relevant consultees (and where applicable, the notifiers(s) of any action) will be advised.

- 8.4 Notifiers of any omissions or inaccuracies will also be given the opportunity to make representations if they disagree with the Council's determination of any action on the matter, which may result in the Council making a further determination/decision on the matter.

9. THE STATUTORY CONSULTATION PROCESS – ADDITIONAL INFORMATION

- 9.1 The current requirements for consulting are set out in the Schools (Consultation) (Scotland) Act 2010. This consultation will be carried out in accordance with the Act.

- 9.2 This consultation has been planned in order to meet the statutory requirements.
- 9.3 The consultation document sets out the details of the proposal.
- The proposal paper details the educational benefits of the proposal and other relevant information.
 - The proposal paper will be published and widely advertised.
 - North Lanarkshire Council will seek to determine whether there are inaccuracies or omissions within the proposal paper and take such action as it considers necessary.
 - The consultation period will be a period of at least 6 weeks including at least 30 school days.
- 9.4 Prior to the commencement of the consultation period, the authority will give notice of the proposal to the relevant consultees. The relevant consultees are defined in the Schools (Consultation) (Scotland) Act 2010, and are as follows:
- (a) The parent council or combined parent council of any affected school
 - (b) The parents of the pupils at any affected school
 - (c) The parents of any children expected by the education authority to attend the affected school within two years of the date of publication of the proposed paper
 - (d) The pupils at any affected school (in so far as the education authority considers them to be of suitable age and maturity)
 - (e) The staff (teaching and other) at any of the affected school(s)
 - (f) Any trade union which appears to the education authority to be representative of the persons mentioned above
 - (g) The community council (if any)
 - (h) The community planning partnership (within the meaning of section 4(5) of the Community Empowerments (Scotland) Act 2015 for the area of the local authority in which any affected school is situated
 - (i) Any other community planning partnership that the education authority considers relevant
 - (j) Any other education authority that the education authority considers relevant
 - (k) Any other users of any affected school that the education authority considers relevant.
- 9.4 During the consultation period, the authority will hold and be represented at public meetings on the relevant proposal.
- 9.5 The council will involve Education Scotland in the consultation process. This will culminate in Education Scotland preparing and submitting an independent report on the educational aspects of the proposal.
- 9.6 Following the consultation period, the council will prepare and publish a consultation report. The report will be published at least three weeks before a final decision is taken on the proposal.
- 9.7 The consultation timeline provides further information on the timescales for various staged in the statutory process.

Please click on the link below to share your views on the proposal (Ctrl + Click to follow link)

www.northlanarkshire.gov.uk/Glenboig-consultation

Appendix 2 – Red Line Boundary

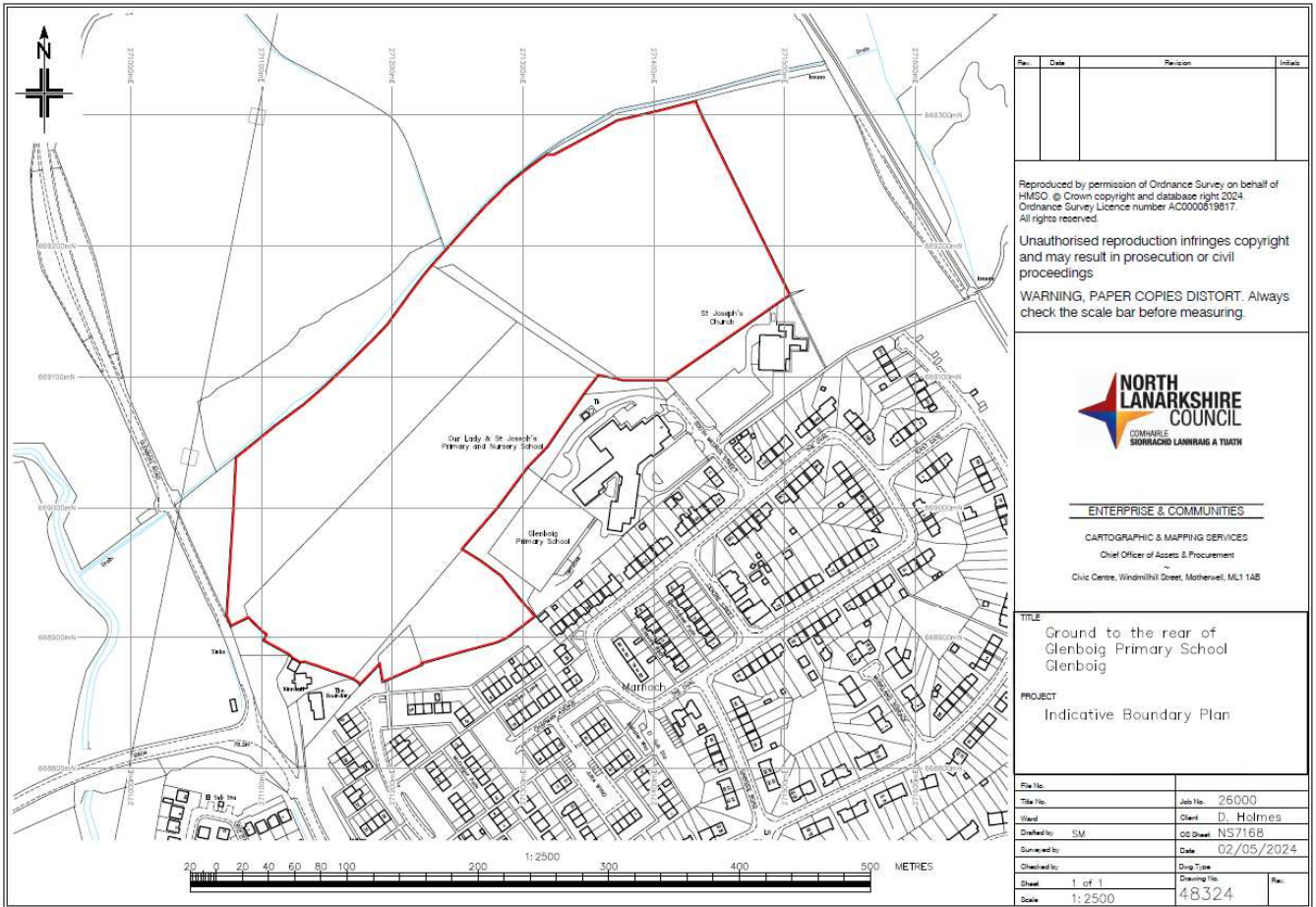

Rev.	Date	Revision	Issued

Reproduced by permission of Ordnance Survey on behalf of HMRC © Crown copyright and database right 2024. Ordnance Survey Licence number AC0000819817. All rights reserved.

Unauthorised reproduction infringes copyright and may result in prosecution or civil proceedings

WARNING, PAPER COPIES DISTORT. Always check the scale bar before measuring.



ENTERPRISE & COMMUNITIES

CARTOGRAPHIC & MAPPING SERVICES
 Chief Officer of Assets & Procurement
 Civic Centre, Windmillhill Street, Motherwell, ML1 1AB

TITLE
 Ground to the rear of
 Glenboig Primary School
 Glenboig

PROJECT
 Indicative Boundary Plan

File No:	Job No:	26000
Title No:	Client:	D. Holmes
Ward:	CB Sheet:	NS7168
Drafted by:	SM	Date:
Submitted by:	SM	Date:
Checked by:	SM	Drawn by:
Sheet:	1 of 1	Drawing No:
Scale:	1:2500	48324

Appendix 3 - Indicative Timeline for Consultation

Stages	Timeline (30 calendar days of consultation excludes weekends/ school holidays/term days, etc)	Date
1. Committee Date		10 September 2024
2. Consultation Starts Phase 1	Minimum of 6 weeks To include 30 calendar days	11 September 2024
3. Public Meeting	Mid-way through consultation period	w/b 30 September 2024
4. Consultation Ends	30 Days (37 days in total to account for 27/9/2024 and 30/9/2024 and 14/10/2024 to 18/10/2024)	29 October 2024
5. Report to Education Scotland (ES) Phase2	Minimum 3 weeks	26 November 2024
6. Education Scotland produce report	Minimum 3 weeks (to be agreed with ES)	TBC
7. Consultation report published Phase 3	No specified timescale	TBC
8. Time for further consideration	3 weeks from publication date	TBC
9. Final Committee Decision		20 May 2025
10. Implement proposal if approved by Committee	3 weeks	TBC